



ENGEL JACOBS
LONDON+HERTS



- **First Floor Modern Apartment**
- **Fitted Kitchen**
- **Balcony**
- **One Bedroom**
- **Large Reception**
- **Allocated Parking Space**



Caulfield Gardens
Pinner

Monthly Rental Of
£1,275

Entrance Hall

Laminated wood floor, spotlights, radiator, video entry phone, storage cupboard.

Bedroom 14' 8" x 10' 6" (4.47m x 3.20m)

Carpeted throughout, fully fitted wardrobes, double glazed windows to front aspect, radiator.

Reception 13' 8" x 12' 6" (4.16m x 3.81m)

Laminated wood floor, spotlights, radiator, double glazed windows and door to balcony at front aspect.

Kitchen 8' 1" x 7' 10" (2.46m x 2.39m)

Laminated wood floor, fully fitted units both wall mounted and base, ample work surface area, integrated Bosch fridge/freezer, integrated Bosch washer/dryer, integrated Bosch dishwasher, Bosch single oven and gas hob, spotlights.

Bathroom 6' 11" x 6' 10" (2.11m x 2.08m)

Tiled floor, partly tiled walls, low level WC, wash basin with mixer tap, bath with overhead shower, heated towel rail, mirrored storage cupboard, spotlights

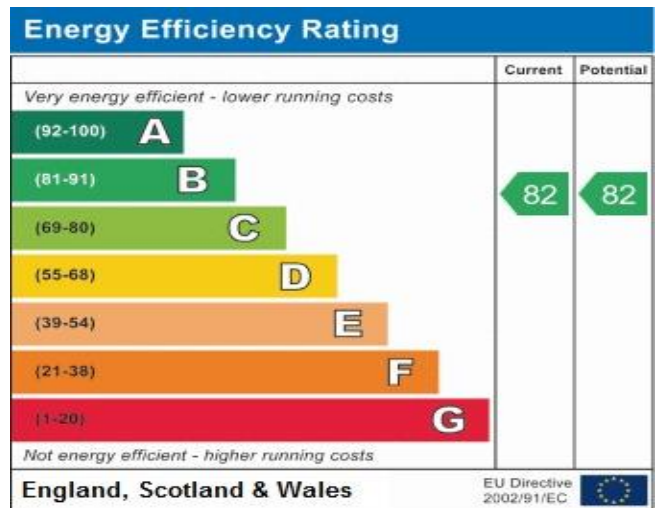

Address:
Flat 4, 2 Caulfield Gardens

First Floor

Approx. 47.3 sq. metres (509.6 sq. feet)

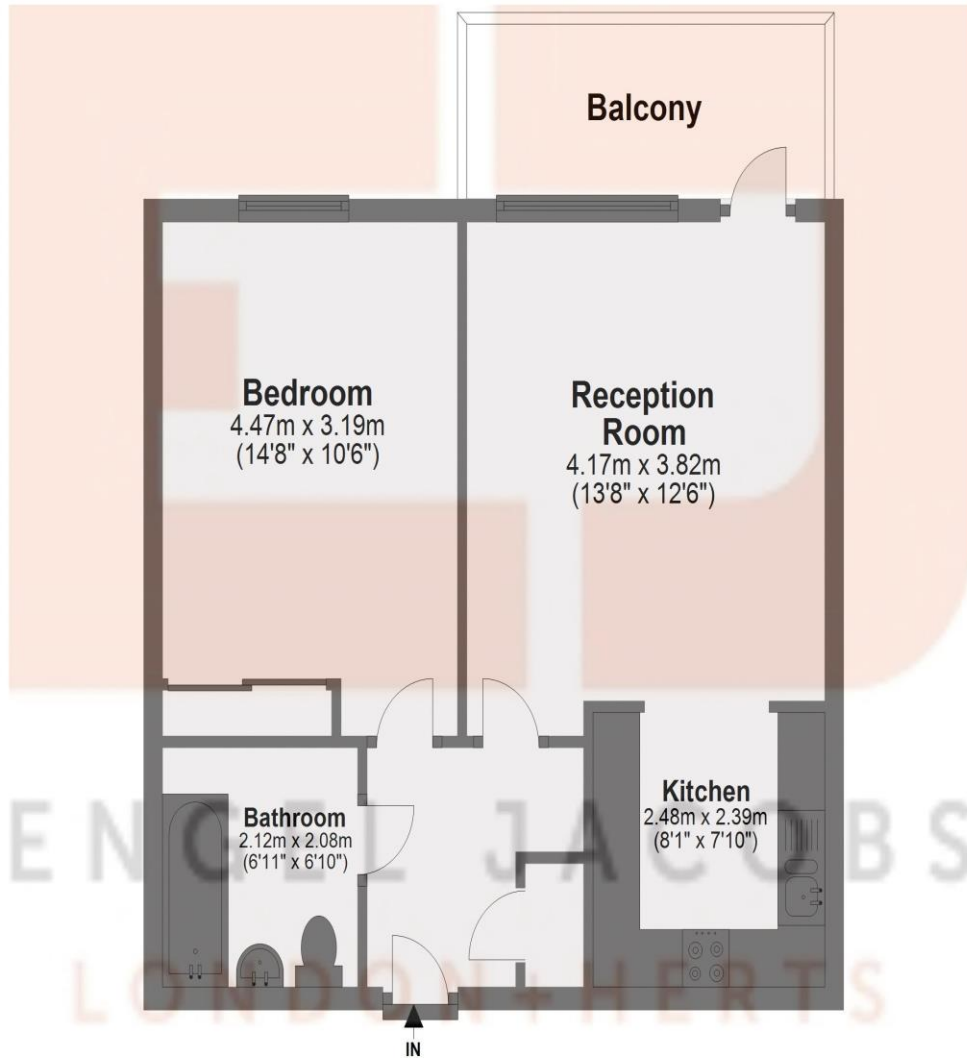

Total area: approx. 47.3 sq. metres (509.6 sq. feet)